

# 120VAC Universal Receptacle EV Charging Station



Plug-in electric vehicles are becoming popular due to rising fuel costs and environmental concerns.

Eaton's EV Charging Station provides a safe and reliable means to quickly power up Electric Vehicles.

#### Features and Benefits:

- Perfect for charging Electric Vehicles (with their respective cordsets), e-bikes, NEVs, electric service vehicles, and golf carts
- 110/120VAC
- 20, 40, and 80 amp units available
- Charge up to four vehicles
- Pedestal and Bollard styles available
- Locking provision to prevent cordset theft
- Support hook to prevent unintentional unplug with heavier EV cordsets
- Charging stations can be connected in series
- NEMA 5-20 T-slot receptacles
- Rugged stainless steel construction
- Indoor / outdoor rated
- Optional LED lighting available
- Optional utility grade sub-metering
- NEC® 625 compliant
- UL® Listed to UL 2594 for EV use
- Customization available



Powering Business Worldwide

Celebrating  
**100** YEARS  
Ideals that Endure

**Table 1. Specifications**

Description	
<b>Electrical Input</b>	
Voltage	110/120V AC
Amperage	20A, 40A, 80A (Pedestal for 1-4 Vehicles)
<b>Electrical Output</b>	
Power	Up to 1.9kW @ 16A Per Connection
Connection	1-4 NEMA 5-20T Receptacles (Pedestal Mount)
<b>Physical / Environmental Specifications</b>	
Pedestal Dimensions – HxWxD	50" x 10" x 10"
Bollard Dimensions – HxWxD	36" x 10" x 10"
Operating Temperature	-30°C to 50°C
Enclosure Rating	NEMA Type 3R
<b>Safety Specifications</b>	
Listed to UL 2594 for EV Use	✓
Listed to cUL for EV Use	✓
Ground Fault Protection	✓
Over-Current Protection	✓

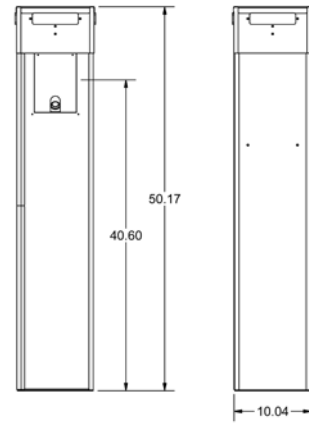

**Pedestal Dimensions**

**Table 2. Catalog Information**

Description			
Type	EVSE		
Level	CR = Universal Receptacle		
No. of Receptacles available	(1) 20 Amp Receptacle	(2) 20 Amp Receptacles	(4) 20 Amp Receptacles
Mount	P = Pedestal	B = Bollard	

Customization available - Contact 1-855-ETN-EVSE for details.

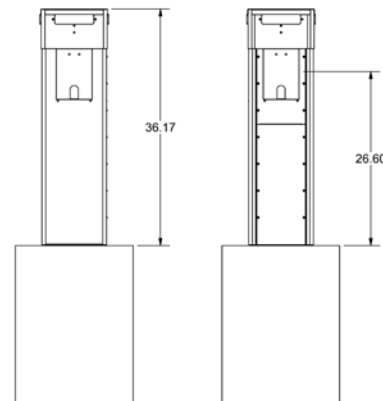
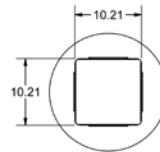

**Bollard Dimensions**

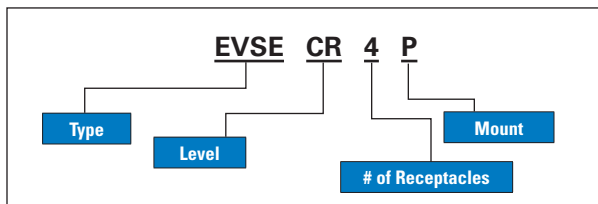

**Eaton Corporation**  
 Electrical Sector  
 1111 Superior Ave.  
 Cleveland, OH 44114  
 United States  
 855-ETN-EVSE (855-386-3873)  
 www.eaton.com/plugin

© 2011 Eaton Corporation  
 All Rights Reserved  
 Printed in USA  
 Publication No. PA00406001E  
 June 2011



Proud Sponsor of



For installation services visit us online to find an Eaton Certified Contractor @ [www.eaton.com](http://www.eaton.com).

The National Electrical Code is a registered trademark of the National Fire Protection Association.

UL is a registered trademark of Underwriters Laboratories.

All other trademarks are property of their respective owners.